



PowerFilm

RA-5 Battery Charger Quick Start Guide

Consult the RA-5 battery charger manual for complete official instructions

For Charging Rechargeable Lithium (Li) Batteries:

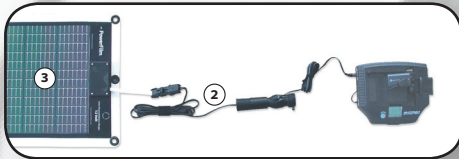

1. Connect the RA-5 Battery Charger to your PowerFilm® Rollable Solar Panel using the included 12V male cigarette lighter adapter (1).
2. Connect the battery charger's 12V male cigarette lighter adapter (1) to the RA-2 Female Cigarette Lighter Adapter (2).
3. Connect the RA-2 Female Cigarette Lighter adapter (2) to the PowerFilm® Rollable Solar Panel (3).

Upon successful connection the battery charger will beep and the Rollable Solar Panel's voltage will appear on the battery charger's LCD display (4).

4. Find the switch on the RA-5 Battery Charger to switch between Ni and Li charging (5).

Switch it to Lithium (Li) charging.

5. Place your Li battery on the battery charger's magnetic holding platform (6). Make sure the contact points on the battery are facing the charger's moveable electrodes (7).
6. Adjust the battery charger's movable electrodes (7) till they touch the correct contact points on the battery.
7. If **"Quick Charge"** appears on the charger's LCD display (4) along with the battery's voltage, the battery is successfully connected.

If **"Err1"** appears on the charger's LCD display (4) and a sustained beep goes off, flip the polarity switch (left or right) below the display (8).

If beep continues, there is either not enough sun, the battery voltage is over 7.2 V, and/or it is still incorrectly connected.

Trial and Error will not harm the battery or charger.

For Charging Rechargeable (NiCad or NiMH) AAA, AA, C, or D Batteries:

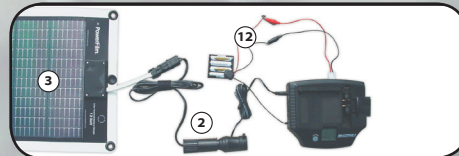

1. Connect the RA-5 Battery Charger to your PowerFilm® Rollable Solar Panel using the included 12V male cigarette lighter adapter (1).
2. Connect the battery charger's 12V male cigarette lighter adapter (1) to the RA-2 Female Cigarette Lighter Adapter (2).
3. Connect the RA-2 Female Cigarette Lighter adapter (2) to the PowerFilm® Rollable Solar Panel (3).

Upon successful connection the battery charger will beep and the Rollable Solar Panel's voltage will appear on the battery charger's LCD display (4).

4. Find the switch on the RA-5 Battery Charger to switch between Ni and Li charging (5). Switch it to NiCad (Ni) charging.

RA-5 Deluxe Universal Battery Charger/ Analyzer/ Conditioner

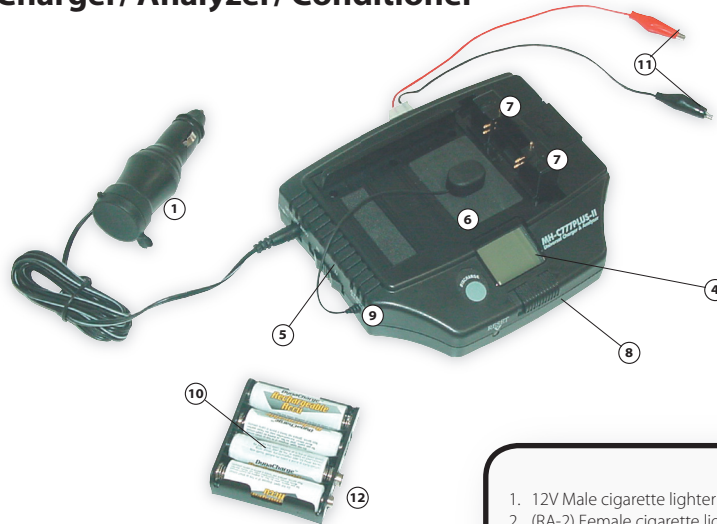

1. 12V Male cigarette lighter adapter
2. (RA-2) Female cigarette lighter adapter
3. PowerFilm® Rollable Solar Panel
4. LCD display
5. Ni / Li charging switch
6. Magnetic holding platform
7. Charger's moveable electrodes
8. Charger's polarity switch
9. Battery analyzer
10. Battery holder (AA/AAA/D)
11. Alligator clips
12. Battery Holder's wires

5. Place rechargeable batteries in the corresponding battery holder (10).
6. Connect the RA-5 Battery Charger's alligator clips (11) to the battery holder's wires (12). Black goes with black, red goes with red.
7. If **"Quick Charge"** appears on the charger's LCD display (4) along with the battery's voltage, the battery is successfully connected.

If **"Err1"** appears on the charger's LCD display (4) and a sustained beep goes off, flip the polarity switch (left or right) below the display (8).

If beep continues, there is either not enough sun, the battery voltage is over 7.2 V, and/or it is still incorrectly connected.

Trial and Error will not harm the battery or charger.